

InspiraTIONS

A NEWSLETTER OF INSPIRING IDEAS FOR HOME AND GARDEN • NOVEMBER 2013

Welcome...to the
Fall 2013 *Inspirations*
newsletter!

This newsletter
explores the warmth
and richness of new
neutral-colored fabrics,
paint colors, and
metals, that stand the
test of time.

Also, read about
my clients' Phase-
III dream-home
addition and remodel
that is in the final
construction stage!

–Rhonda–



Where do you find *your* inspiration?



A neutral scheme of fabrics, flooring, and walls is a perfect choice for many of my clients' homes. A client may ask for light, neutral furnishings so she can change accessories in her house with the change in seasons. Others prefer white-on-white or beige interiors because they have vibrant art throughout their home. I also recommend neutral interiors when my clients' have sweeping views of outdoor landscapes, a lake or pond; the changing colors of nature will be even more pleasing when not competing with artificial indoor colors.

Realizing a Dream Home after 15 on a North Liberty Acreage

When I began consulting with them on the new interiors, I studied the blue-prints, and pages of favorite room photos the husband and wife had gathered from Houzz.com and magazines. This allowed me to define the family's use of the new and enlarged spaces, and understand the style they envisioned for the interiors.

In the late 1990's, a run-down ranch-style house on an acreage west of the Coralville and North Liberty line came up for sale, and after harrowing negotiations, the final bidder, a realtor and developer, called his fiancé to tell her that he had purchased their first home.....after that, the couple embarked on one, then another, and now the final renovation and additions to the house.

Now, in the fall of 2013, the couple and their pre-teen children are only a few months away from realizing their dream—an enlarged home for extended family and guests to gather for dinners and momentous events, for the family and their sports teams to hang out, exercise or play basketball—in an indoor court, no less!

The new windows, kitchen design and cabinetry came first, followed by flooring choices, fireplace wall and mantel designs, and bathroom fixtures. In the meantime, the house walls were torn out to the studs, the additions constructed, and re-wiring and plumbing began. Now with drywall and painting next, the house will be a completed in March.

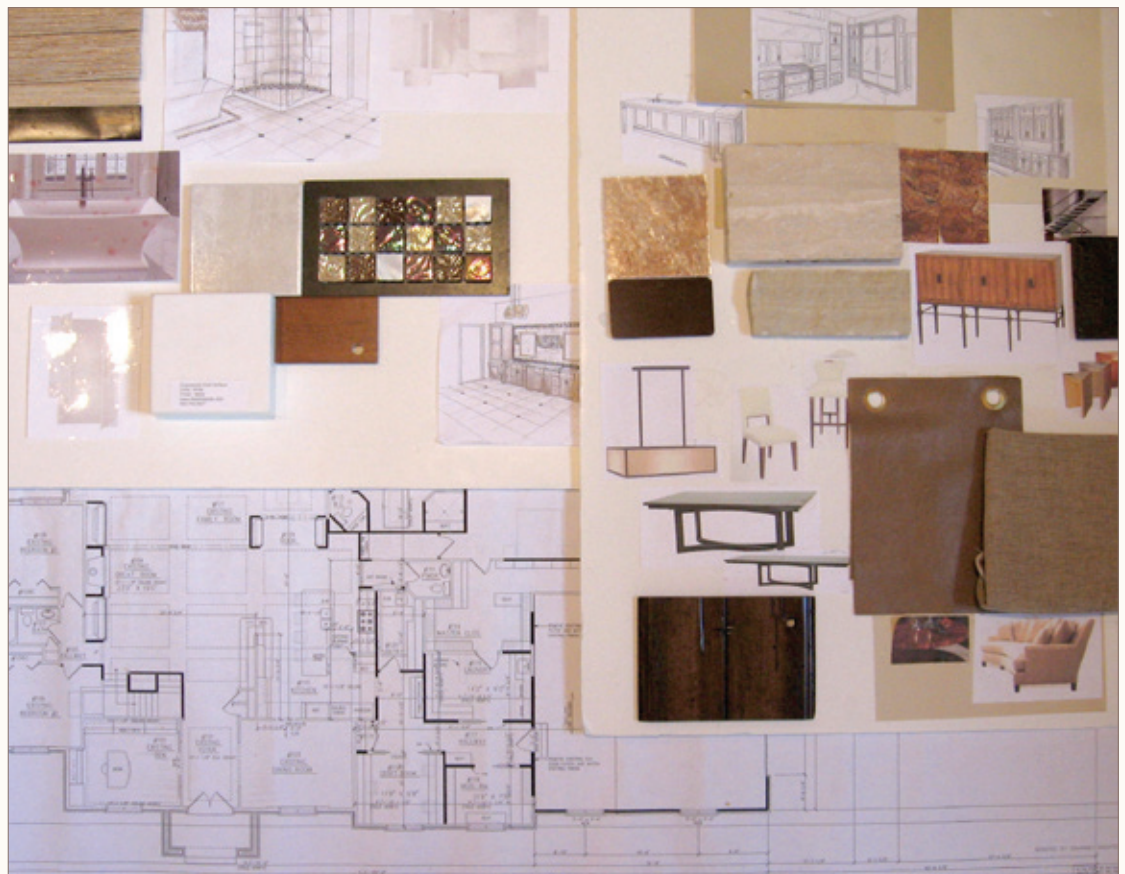

5 Years,

REINVENTION

It's all about the details



In the remodel of this home's Master bath, my clients researched soaking tubs from MTI's Boutique collection. Constructed of a patented mixture of ground natural minerals and binding agents that are liquefied, poured, and hardened. It is non-porous and makes cleaning easy.



The sideboard I suggested for my client's family dining area has a practical custom feature: I have designed the 3 doors to fold back to house 2 large dining table leaves. The shelves will be covered in protective felt, and when my client wants to expand the nearby table, the leaves are cleverly-stored just steps away.

Bausman & Co. Sideboard at The Mansion

GOLD-TONES , PAST AND PRESENT

Over ten years ago there began a swing in popularity to chrome and nickel for bath faucets, door hardware and light fixtures. From contemporary to vintage interiors, silver-tones seemed to reign supreme as the trend, and were the most available from manufacturers.



As the interior design world continually re-invents new trends from the past, I am not surprised that interior metal-tones have emerged, and in-force! Antiqued brass, oil-rubbed bronze, gold leaf, and coppers are abundantly available, and can find a place with any decor.

"Pinkston" Lamp \$465 (above, right)

"Arcs " gold leaf accessory \$315 (right)

"Fontainebleau" Floor lamp in antique-burnished brass \$1,155 (left)



In THE KNOW

SECRETS FOR SELECTING THE PERFECT PAINT COLOR

The ideal way to select a paint color for walls, is to select the fabrics for furnishings and flooring first, *then*, look at paint swatches to complement the fabrics and flooring.

I look at the fabrics and flooring in each room at my client's home, to judge the natural day-light quality from their windows, as well as artificial light from recessed cans and lamps.

A postage stamp-sized paint swatch will not do. I have 2 or more paint colors mixed at the paint store in quarts and rolled on areas of each room to make my final decision.

Painted base boards and trim will set off neutral or colorful paint the best; stained wood trim will detract from paint colors I prefer an off-white enamel for trim, such as Sherwin Williams Dover White.

FAVORITE PAINT COLORS:

- Sherwin Williams**
- SW6099 Sand Dollar
- SW0036 Buckram Binding
- SW7680 Lanyard
- SW6163 Grassland
- SW6210 Window Pane
- SW7023 Requisite Gray

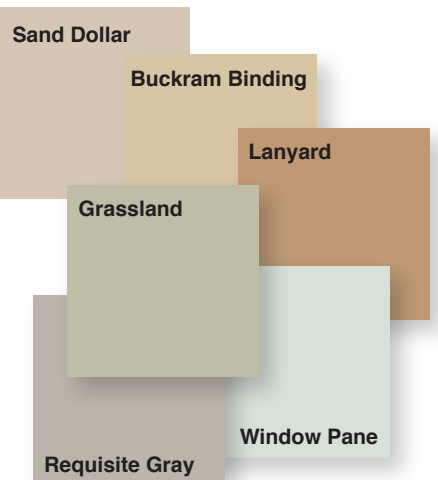

Inspiring Event, November 16TH and 17TH



The Iowa City Junior Service League has planned a Holiday Home Tour of three beautiful local homes, and this year 100% of the proceeds benefit “Operation Backpack” for the Iowa City Community School District. “Operation Backpack” allows our school district to send boxed meals and other food staples home with school children from families in need, to ensure that they have enough to eat all week long. The tickets are \$12 and may be purchased at each home or in advance, on-line at www.ICJSL.org.

I was selected for a home on the tour, and I chose the beautiful U of I Gamma Phi Beta home at 328 N. Clinton, built in 1925, of which I have worked on, both renovating and redecorating for the past ten years.

Please join me and tour the main rooms of this gracious home, decorated for the holidays like never before!

THE NEXT ISSUE



New Iowa City Kitchen Remodel and 3-Season Room Addition

Designer Tips for Bedrooms



And more!

Favorite Window Treatment



The large valance of this casual-yet-elegant window treatment at the Gamma Phi Beta House on the University of Iowa Campus, is called a Kingston Valance. Obviously, by its name, it is of English heritage, and it is loosely held by rings on a decorative rod—from my favorite custom company Le Fer Forge. The fabric, a simple polyester linen-look-a-like (all Gamma Phi Beta fabrics in the house have to be rated fire-resistant and this fabric was suitable), is dressed-up with a tassel fringe. The pleats are very relaxed, and were hand-sewn by my drapery workroom. (Not a rigid factory-made pleat.) And, if the lining should “peak-out” ... well, I took care if that! It is a contrasting fabric that accents the room’s color-scheme. It is all in the details ...

Know someone who may enjoy this newsletter?

Please contact:
Rhonda Staley IIDA
538 S. Gilbert Street
THE MANSION
Iowa City IA 52240
c. 319-321-2404
o. 319-338-2830
rstaley@themansion-interiors.com
www.rhondastaley.com